



WHICH WINCH? PREMIER WINCH.

CONTACT YOUR DEALER



**4x4
SELF-RECOVERY WINCHES**

www.premierwinch.com.au

www.premierwinch.com.au

PREMIER

THE PREMIER WINCH HAS ALL ITS HIDDEN FEATURES EXPOSED TO YOUR SCRUTINY...



Premier is the only four-star winch on the market. Independent testing by 4x4 Australia magazine determined the Premier “did well in the loaded line-pull tests (bettering) the more powerful 9500lb units in line speed and current draw”.

The premier was developed in response to customer requests for a better quality, cost-effective winch.

Because of its industrial origins, the Premier is the only vehicle-mounted winch rated for vertical lifting as well as horizontal pulling. Industrial lifting equipment requires a much greater margin for safety, making the Premier far more capable than its rated load indicates. It also explains why the 4.6HP motor rating is an actual rating – like the difference between flywheel HP and rear-wheel HP in cars – the Premier is rated ‘at the rear wheel’. So the available horsepower doesn’t drop under load.

And because only the Premier winch motor was designed this way from the start, it’s more effective, more efficient electrically, and independent testing proves it uses far less current under load than any other winch.

We call it ‘Premier’ because we’re confident it’s the best.

WINCH

...AND THIS IS WHAT MAKES IT SO GOOD...

- ➔ Genuine 4.6 horsepower unit – rated at drum, not at the motor. Brush mounts easier to service
- ➔ Tie rods are solid steel (not hollow) for added strength, and are chromed for protection and long service life
- ➔ Motor, gearbox and shaft are all supported by five sealed roller bearings (not keyways or bushes) making for a stronger shaft
- ➔ T-handle clutch lever has spring-loaded plunger pin, locating in a machined recess in the clutch pack for positive locking
- ➔ Larger brake diameter exerts greater braking force and its location on the outer end of the drive shaft (rather than inside the cable drum) prevents excess heat build-up in the drum, enabling safe use of plasma rope
- ➔ Cable drum has significantly thicker walls for additional strength
- ➔ The gears are heat-treated (not sintered) a much tougher hardening process
- ➔ The mounting bolt location is to the standard pattern, so the Premier will fit most bullbars easily
- ➔ Ergonomic hand controller has protected rocker switch and a 5.0m lead. The longest of any winch on the market
- ➔ The rotating ring gear clutch has a steel (not weaker alloy) casing, and is far less susceptible to jamming than those with a sliding type clutch
- ➔ The clevis hook on the cable end has a spring-loaded ‘keeper’ making it much safer than those without
- ➔ Cable-end anchor is located in a machined groove in the cable drum, retained by an Allen-head grub screw
- ➔ Cable plug mount screwed (not riveted) to solenoid. Longer motor-to-controller cables provide for better choice of controller location



SELF-RECOVERY WINCH DV-6000S

DV-6000S - Features

- ➔ Heavy duty series wound motor gives high torque and fast line speed.
- ➔ 3 stage planetary gearbox delivers the most reliable and durable performance even under worst conditions.
- ➔ Patented automatic cone brake holds full load easily. The greater the load on the wire rope, the greater amount of brake force is applied by the mechanism.
- ➔ Rotating ring gear free spool designed to pull and turn for rapid wire rope payout.
- ➔ Compact design ideal for light 4x4 recovery, trailer and utility applications.

Specifications

Line Pull	2,722 kg
Motor 12V	2,386 w
Motor 24V	1,492 w
Gear Train	3 stage planetary gears
Gear Ratio	216 : 1
Freespool	rotating ring gear
Brake	automatic, full load cone brake
Wire Rope Size	7.14 mm x 24.4 m
Wire Rope Type	galvanized aircraft A7 x19
Drum Size	63.5 mm x 125.5 mm
Mounting Bolt Pattern	152.4 mm x 114.3 mm

Line Pull and Rope Capacity

Layer of wire rope	Line Pull kg/lb	Total Rope on the Drum m/ft
1st Layer	2,722 / 6,000	3.6 / 11.8
2nd Layer	2,264 / 4,991	7.8 / 25.6
3rd Layer	1,938 / 4,273	12.8 / 42
4th Layer	1,694 / 3,735	18.5 / 60.7
5th Layer	1,505 / 3,318	24.4 / 80

Dimensions

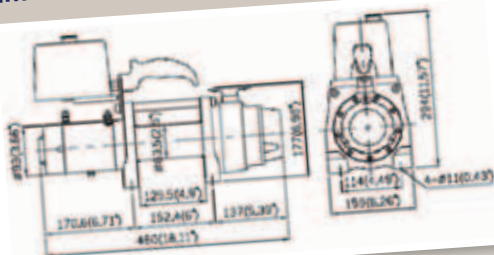

Line Speed and Amp. Draw (1st layer of rope on the drum)

Line Pull kg/lb	Line Speed mpm/fpm	Amp. Draw 12V	Amp. Draw 24V
No Load	8.0 / 26.2	60	35
907 / 2,000	5.2 / 17	150	90
1,814 / 4,000	3.1 / 10.2	240	140
2,722 / 6,000	2.0 / 6.5	300	200



SELF-RECOVERY WINCH DV-9000ES MID FRAME

DV-9000ES - Features

- ➔ Heavy duty series wound motor gives high torque and fast line speed.
- ➔ 3 stage planetary gearbox delivers the most reliable and durable performance even under worst conditions.
- ➔ Patented automatic cone brake holds full load easily. The greater the load on the wire rope, the greater amount of brake force is applied by the mechanism.
- ➔ Rotating ring gear free spool designed to pull and turn for rapid wire rope payout.
- ➔ Submersible sealed contactor handles high amps and allows higher duty cycle.

Dimensions

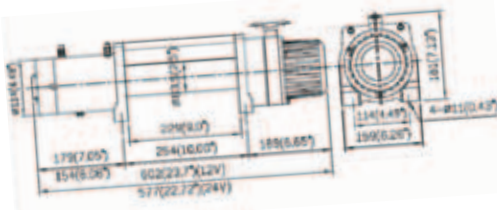

Specifications

Line Pull	4,082 kg
Motor 12V	3,430 w
Motor 24V	1,940 w
Gear Train	3 stage planetary gears
Gear Ratio	156 : 1
Freespool	rotating ring gear
Brake	automatic, full load cone brake
Wire Rope Size	8.3 mm x 30 m
Wire Rope Type	galvanized aircraft A7 x19
Drum Size	63.5 mm x 229 mm
Mounting Bolt Pattern	254 mm x 114 mm

Line Pull and Rope Capacity

Layer of wire rope	Line Pull kg/lb	Total Rope on the Drum m/ft
1st Layer	4,082 / 9,000	6.1 / 20
2nd Layer	3,335 / 7,352	13.5 / 44.3
3rd Layer	2,820 / 6,217	22.3 / 73.2
4th Layer	2,442 / 5,383	30 / 100

Line Speed and Amp. Draw (1st layer of rope on the drum)

Line Pull kg/lb	Line Speed mpm/fpm	Amp. Draw 12V	Amp. Draw 24V
No Load	13.4 / 44	55	30
907 / 2,000	4.6 / 15	110	65
1,814 / 4,000	3.4 / 11	200	100
2,722 / 6,000	2.7 / 9	230	130
3,629 / 8,000	2.3 / 7.5	260	170
4,082 / 9,000	2.0 / 6.4	350	210



SELF RECOVERY WINCH DV-12 light MID FRAME

DV-12 light - Features

- ➔ Reliable electric winch for working and playing in off-road environments.
- ➔ 3,430w/12V or 1,940w/24V series wound motor.
- ➔ Nine equally positioned pin holes make it possible to reposition in 40 degree Increments for customer and in bumper applications.
- ➔ Hardened steel, 3-stage planetary gear train for efficiency and reliability.
- ➔ Patented mechanical CBS (Cone Brake Structure) holds the full load without slipping.
- ➔ Submersible sealed contactor handles high amps and allows higher duty cycle.

Specifications

Line Pull	5,443 kg
Motor 12V	3,430 w
Motor 24V	1,940 w
Gear Train	3 stage planetary gears
Gear Ratio	211 : 1
Clutch (Freespool)	rotating ring gear
Brake (Outside the drum)	automatic, full load cone brake
Rope Size	9.5 mm x 25 m
Rope Type	Galvanized aircraft A7 x19
Drum Size	63.5 mm x 229 mm
Mounting Bolt Pattern	254 mm x 114 mm

Line Pull and Rope Capacity

Layer of wire rope	Line Pull kg/lb	Total Rope on the Drum m/ft
1st Layer	5,443 / 12,000	5.4 / 17.7
2nd Layer	4,319 / 9,522	12.2 / 40.0
3rd Layer	3,580 / 7,893	20.5 / 67.3
4th Layer	3,056 / 6,737	25.0 / 82.0

Dimensions

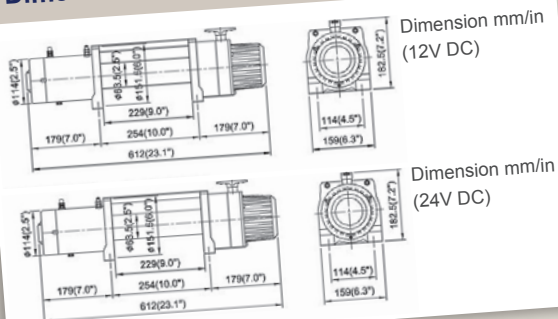

Line Speed and Amp. Draw (1st layer of rope on the drum)

Line Pull kg/lb	Line Speed mpm/ fpm	Amp. Draw 12V	Amp. Draw 24V
No Load	8.0 / 26.2	50	30
1,814 / 4,000	3.0 / 9.8	120	70
3,629 / 8,000	1.5 / 5.0	230	140
4,536 / 10,000	1.2 / 4.0	290	180
5,443 / 12,000	1.0 / 3.3	350	210



SELF-RECOVERY WINCH DV-12000ES LARGE FRAME

DV-12000ES - Features

- ➔ Heavy duty series wound motor gives high torque and fast line speed.
- ➔ 3 stage planetary gearbox delivers the most reliable and durable performance even under worst conditions.
- ➔ Patented automatic cone brake holds full load easily. The greater the load on the wire rope, the greater amount of brake force is applied by the mechanism.
- ➔ Rotating ring gear free spool designed to pull and turn for rapid wire rope payout.
- ➔ Heavy-duty sealed solenoid provides better water resistance and lower amp. draw.

Specifications

Line Pull	5,443 kg
Motor 12V	4,175 w
Motor 24V	2,684 w
Gear Train	3 stage planetary gears
Gear Ratio	216 : 1
Freespool	rotating ring gear
Brake	automatic, full load cone brake
Wire Rope Size	9.5 mm x 38 m
Wire Rope Type	galvanized aircraft A7 x19
Drum Size	89 mm x 206 mm
Mounting Bolt Pattern	254 mm x 114.3 mm x 165.1 mm

Line Pull and Rope Capacity

Layer of wire rope	Line Pull kg/lb	Total Rope on the Drum m/ft
1st Layer	5,443 / 12,000	6.2 / 20.3
2nd Layer	4,561 / 10,056	13.6 / 44.6
3rd Layer	3,926 / 8,657	22.1 / 72.5
4th Layer	3,446 / 7,599	31.9 / 105
5th Layer	3,070 / 6,770	38 / 125

Dimensions

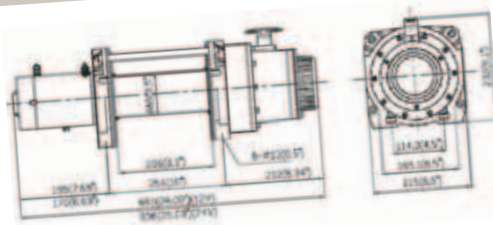

Line Speed and Amp. Draw (1st layer of rope on the drum)

Line Pull kg/lb	Line Speed mpm/fpm	Amp. Draw 12V	Amp. Draw 24V
No Load	8.3 / 27	60	50
1,814 / 4,000	2.6 / 8.6	200	100
3,629 / 8,000	1.7 / 5.8	310	190
4,535 / 10,000	1.4 / 4.4	370	230
5,443 / 12,000	1.2 / 4	440	290



SELF-RECOVERY WINCH DV-15000ES LARGE FRAME

DV-15000ES - Features

- ➔ Heavy duty series wound motor gives high torque and fast line speed.
- ➔ 3 stage planetary gearbox delivers the most reliable and durable performance even under worst conditions.
- ➔ Patented automatic cone brake holds full load easily. The greater the load on the wire rope, the greater amount of brake force is applied by the mechanism.
- ➔ Rotating ring gear free spool designed to pull and turn for rapid wire rope payout.
- ➔ Heavy-duty sealed solenoid provides better water resistance and lower amp. draw.

Specifications

Line Pull	6,803 kg
Motor 12V	4,175 w
Motor 24V	2,684 w
Gear Train	3 stage planetary gears
Gear Ratio	315 : 1
Freespool	rotating ring gear
Brake	automatic, full load cone brake
Wire Rope Size	11 mm x 27 m
Wire Rope Type	6 x W(19) + IWRC
Drum Size	89 mm x 206 mm
Mounting Bolt Pattern	254 mm x 114.3 mm x 165.1 mm

Line Pull and Rope Capacity

Layer of wire rope	Line Pull kg/lb	Total Rope on the Drum m/ft
1st Layer	6,803 / 15,000	5.3 / 17.4
2nd Layer	5,575 / 12,292	11.8 / 38.7
3rd Layer	4,723 / 10,413	19.5 / 64
4th Layer	4,097 / 9,033	27 / 89

Line Speed and Amp. Draw (1st layer of rope on the drum)

Line Pull kg/lb	Line Speed mpm/fpm	Amp. Draw 12V	Amp. Draw 24V
No Load	6.9 / 22	60	50
1,814 / 4,000	1.6 / 5.4	180	90
3,629 / 8,000	1.2 / 3.8	280	190
4,535 / 10,000	1 / 3.3	330	220
5,443 / 12,000	0.9 / 2.9	385	260
6,805 / 15,000	0.8 / 2.5	460	340

Dimensions

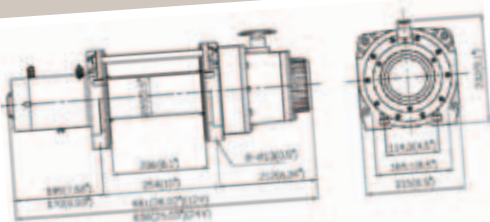

AUTOMOTIVE ACCESSORIES



Cable Tensioner
204mm for use with
DV-12000ES, DV-15000ES
Part N° 88107

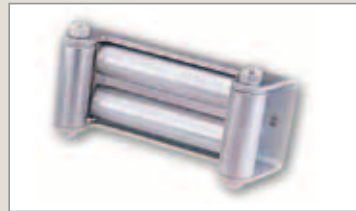

Roller Fairlead
Part N° 880132 109mm for
use with DV-6000S
Part N° 880066 180mm for
use with DV-12000ES/15000ES
Part N° 880023 210mm for
use with DV-9000



Detachable Contactor Pack
For use with
Part N° 880098 for use with
DV-6000S 12V
Part N° 880068 for use with
DV9/12/15/12 Light 12V



Snatch Block
CBV-30 13,610 kg/30,000 lb
Part N° 881079 10000kg for use
with DV6000/DV9000.
Part N° 881082 13610kg for use
with DV12/15/12 Light



Remote Control
Switch CPB-61B W/
3m (10') cord
Part N° 880025 for
DV6000S/9/12/15/12 light



Wire Rope with Hook
Part N° 880083 for use with DV-6000S
Part N° 880010 for use with DV-9000
Part N° 880052 for use with DV-12000
Part N° 881246 for use with DV-15000
Part N° 881285 for use with
DV-12 Light